

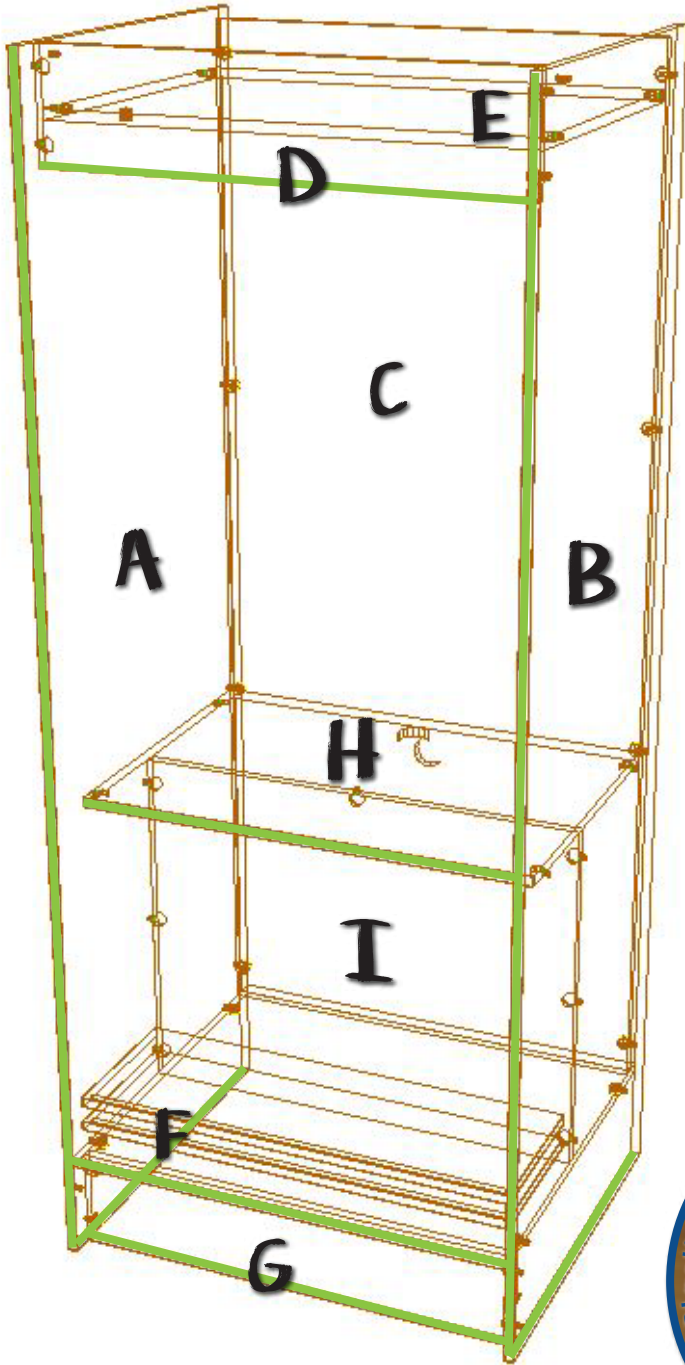

Three Square Market 3329 Casey St.
River Falls, WI 54022 715.386.2233

CHECKOUT FIXTURE



- A - LEFT Side
- B - RIGHT Side
- C - BACK
- D - Ad PANEL
- E - TOP
- F - DECK
- G - TOE KICK
- H - COUNTER TOP
- I - LOWER BACK

All stickers are a low tac removable material. Simply peel the back off and place! Adjust as many times as necessary.



* Edge Banded



Three Square Market 3329 Casey St.
River Falls, WI 54022 715.386.2233

CHECKOUT FIXTURE

1. Lay out all fixture pieces onto a **COMPLETELY FLAT** surface. ***Doing this on an uneven surface may produce breaks in the melamine.** Pound in all clips using the mallet and clip holder provided. ***Hold the clip holder straight up and down.** Make sure all clips are open. Place glue into each shelf cut, insert plexi glass, and leave to dry.
2. Lay A (Left Side) on the floor, holes facing up.
3. Insert C (Back) into A (Left Side). Clips should be facing the back of the fixture. The hole should be closer to the bottom of the fixture. Close the connected clips.
4. Insert E (Top) into A (Left Side). Clips should be facing the top of the fixture. The hole should be positioned in the front, left corner of the fixture. Leave the clips open, for now.
5. Insert D (Ad Panel), **edge banded side facing down**, into A (Left Side). Clips should be facing the back of the fixture. Close the connected clips. Close E's connected clips, now.
6. Insert H (Counter Top), **edge banded side facing the front of the fixture**, into A (Left Side). Clips should be facing the bottom of the fixture. The hole should be closer to the back of the fixture. Close the connected clips.
7. Insert I (Lower Back) into A (Left Side) and H (Counter Top). Clips should be facing the front of the fixture. Leave the clips open, for now.
8. Insert F (Deck), **edge banded side facing the front of the fixture**, into A (Left Side). Clips should be facing the bottom of the fixture. Leave the clips open, for now.
9. Insert G (Toe Kick), **edge banded side facing down**, into A (Left Side). Clips should be facing the back of the fixture. Close the connected clips. Close I and F's connected clips, now.
10. Set B (Right Side) onto the fixture, holes facing down. Work from the top of the fixture to the bottom to line up all holes. ***The rubber mallet is helpful for this.** While holding pressure down on B (Right Side), close all clips.
11. Double check that ALL clips are closed.
12. Roll the fixture onto its back.
13. Set the slatwalls into place. ***Putting a plastic insert into the very bottom, between the slatwall and either H (Counter Top) or F (Deck), is helpful for lining them up correctly.**
14. Screw the slatwalls into place, lining screws into slat grooves. ***We recommend using 1" sheetrock screws.**
15. Insert all plastic slatwall inserts. ***The lip of the insert should face the top of the fixture (see image on other side).** Apply feet to the fixture. Mount LED lighting if provided.
16. **Stand the fixture up, place shelves, & enjoy**

**SEE THE ASSEMBLY VIDEOS
ON 32FIXTURES.COM!**

32FIXTURES.COM



Three Square Market 3329 Casey St.
River Falls, WI 54022 715.386.2233

COFFEE FIXTURE

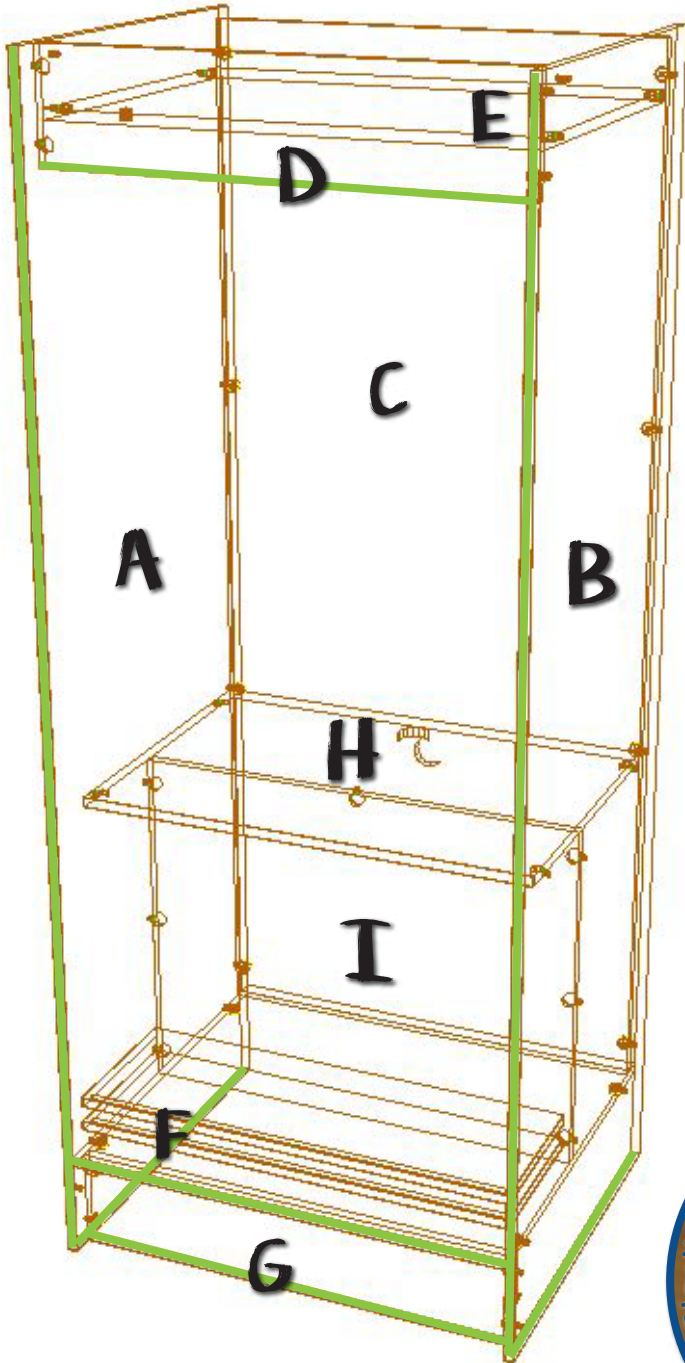

- A - LEFT Side
- B - RIGHT Side
- C - Back
- D - Ad Panel
- E - TOP
- F - DECK
- G - TOE KICK
- H - LAMINATE TOP
- I - LOWER BACK

All stickers are a low tac removable material. Simply peel the back off and place! Adjust as many times as necessary.



* Edge Banded

32FIXTURES.COM



Three Square Market 3329 Casey St.
River Falls, WI 54022 715.386.2233

COFFEE FIXTURE

1. Lay out all fixture pieces onto a **COMPLETELY FLAT** surface. ***Doing this on an uneven surface may produce breaks in the melamine.** Pound in all clips using the mallet and clip holder provided. ***Hold the clip holder straight up and down.** Make sure all clips are open. Place glue into each shelf cut, insert plexi glass, and leave to dry.
2. Lay A (Left Side) on the floor, holes facing up.
3. Insert C (Back) into A (Left Side). Clips should be facing the back of the fixture. The hole should be closer to the bottom of the fixture. Close the connected clips.
4. Insert E (Top) into A (Left Side). Clips should be facing the top of the fixture. The hole should be positioned in the front, left corner of the fixture. Leave the clips open, for now.
5. Insert D (Ad Panel), **edge banded side facing down**, into A (Left Side). Clips should be facing the back of the fixture. Close the connected clips. Close E's connected clips, now.
6. Insert H (Laminate Top) into A (Left Side). Clips should be facing the bottom of the fixture. The hole should be closer to the back of the fixture. Close the connected clips.
7. Insert I (Lower Back) into A (Left Side) and H (Counter Top). Clips should be facing the front of the fixture. Leave the clips open, for now.
8. Insert F (Deck), **edge banded side facing the front of the fixture**, into A (Left Side). Clips should be facing the bottom of the fixture. Leave the clips open, for now.
9. Insert G (Toe Kick), **edge banded side facing down**, into A (Left Side). Clips should be facing the back of the fixture. Close the connected clips. Close I and F's connected clips, now.
10. Set B (Right Side) onto the fixture, holes facing down. Work from the top of the fixture to the bottom to line up all holes. ***The rubber mallet is helpful for this.** While holding pressure down on B (Right Side), close all clips.
11. Double check that ALL clips are closed.
12. Roll the fixture onto its back.
13. Set the slatwall into place. ***Putting a plastic insert into the very bottom, between the slatwall and F (Deck), is helpful for lining it up correctly.**
14. Screw the slatwall into place, lining screws into slat grooves. ***We recommend using 1" sheetrock screws.**
15. Insert all plastic slatwall inserts. ***The lip of the insert should face the top of the fixture (see image on other side).** Apply feet to the fixture. Mount LED lighting if provided.
16. **Stand the fixture up, place shelves, & enjoy**

**SEE THE ASSEMBLY VIDEOS
ON 32FIXTURES.COM!**

32FIXTURES.COM



Three Square Market 3329 Casey St.
River Falls, WI 54022 715.386.2233

2' Slatwall Fixture

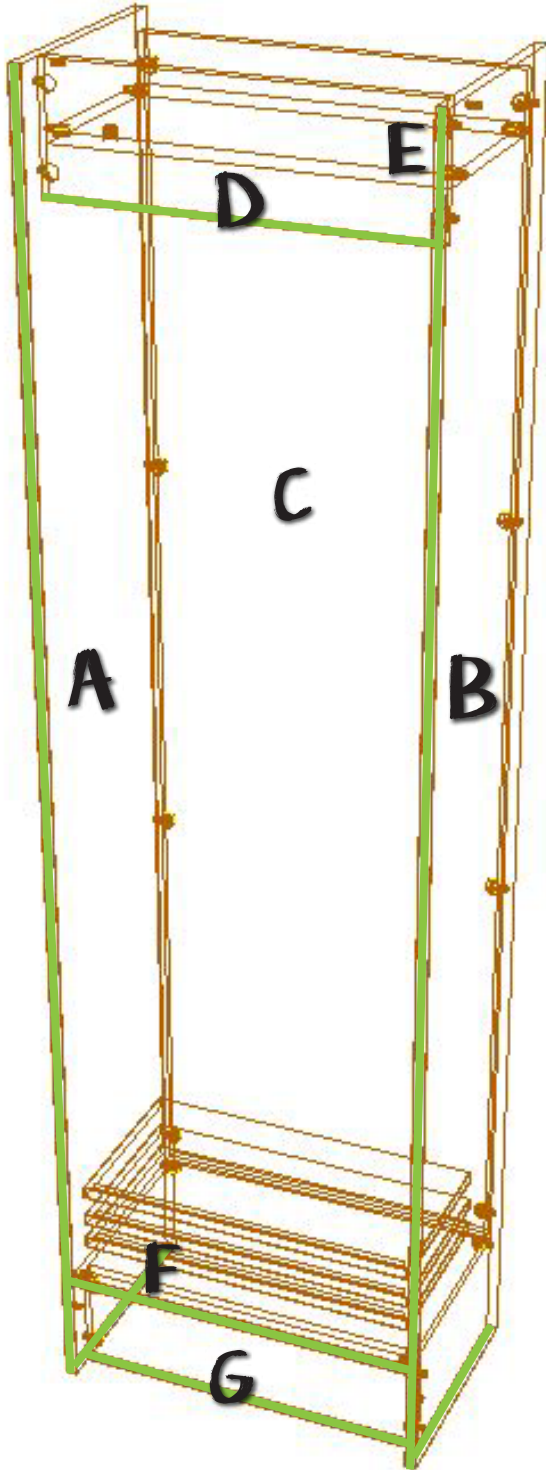

- A - Left Side
- B - Right Side
- C - Back
- D - Ad Panel
- E - Top
- F - Deck
- G - Toe Kick

All stickers are a low tac removable material. Simply peel the back off and place! Adjust as many times as necessary.



* Edge Banded

32FIXTURES.COM



Three Square Market 3329 Casey St.
River Falls, WI 54022 715.386.2233

2' Slatwall Fixture

1. Lay out all fixture pieces onto a **COMPLETELY FLAT** surface. ***Doing this on an uneven surface may produce breaks in the melamine.** Pound in all clips using the mallet and clip holder provided. ***Hold the clip holder straight up and down.** Make sure all clips are open. Place glue into each shelf cut, insert plexi glass, and leave to dry.
2. Lay A (Left Side) on the floor, holes facing up.
3. Insert C (Back) into A (Left Side). Clips should be facing the back of the fixture. Close the connected clips.
4. Insert E (Top) into A (Left Side). Clips should be facing the top of the fixture. The hole should be positioned in the front, left corner of the fixture. Leave the clips open, for now.
5. Insert D (Ad Panel), **edge banded side facing down**, into A (Left Side). Clips should be facing the back of the fixture. Close the connected clips. Close E's connected clips, now.
6. Insert F (Deck), **edge banded side facing the front of the fixture**, into A (Left Side). Clips should be facing the bottom of the fixture. Leave the clips open, for now.
7. Insert G (Toe Kick), **edge banded side facing down**, into A (Left Side). Clips should be facing the back of the fixture. Close the connected clips. Close F's connected clips, now.
8. Set B (Right Side) onto the fixture, holes facing down. Work from the top of the fixture to the bottom to line up all holes. ***The rubber mallet is helpful for this.** While holding pressure down on B (Right Side), close all clips.
9. Double check that ALL clips are closed.
10. Roll the fixture onto its back.
11. Set the slatwall into place. ***Putting a plastic insert into the very bottom, between the slatwall and F (Deck), is helpful for lining it up correctly.**
12. Screw the slatwall into place, lining screws into slat grooves. ***We recommend using 1" sheetrock screws.**
13. Insert all plastic slatwall inserts. ***The lip of the insert should face the top of the fixture (see image on other side).** Apply feet to the fixture. Mount LED lighting if provided.
14. **Stand the fixture up, place shelves, & enjoy**

**SEE THE ASSEMBLY VIDEOS
ON 32FIXTURES.COM!**

32FIXTURES.COM



Three Square Market 3329 Casey St.
River Falls, WI 54022 715.386.2233

COOLER SURROUND DOUBLE

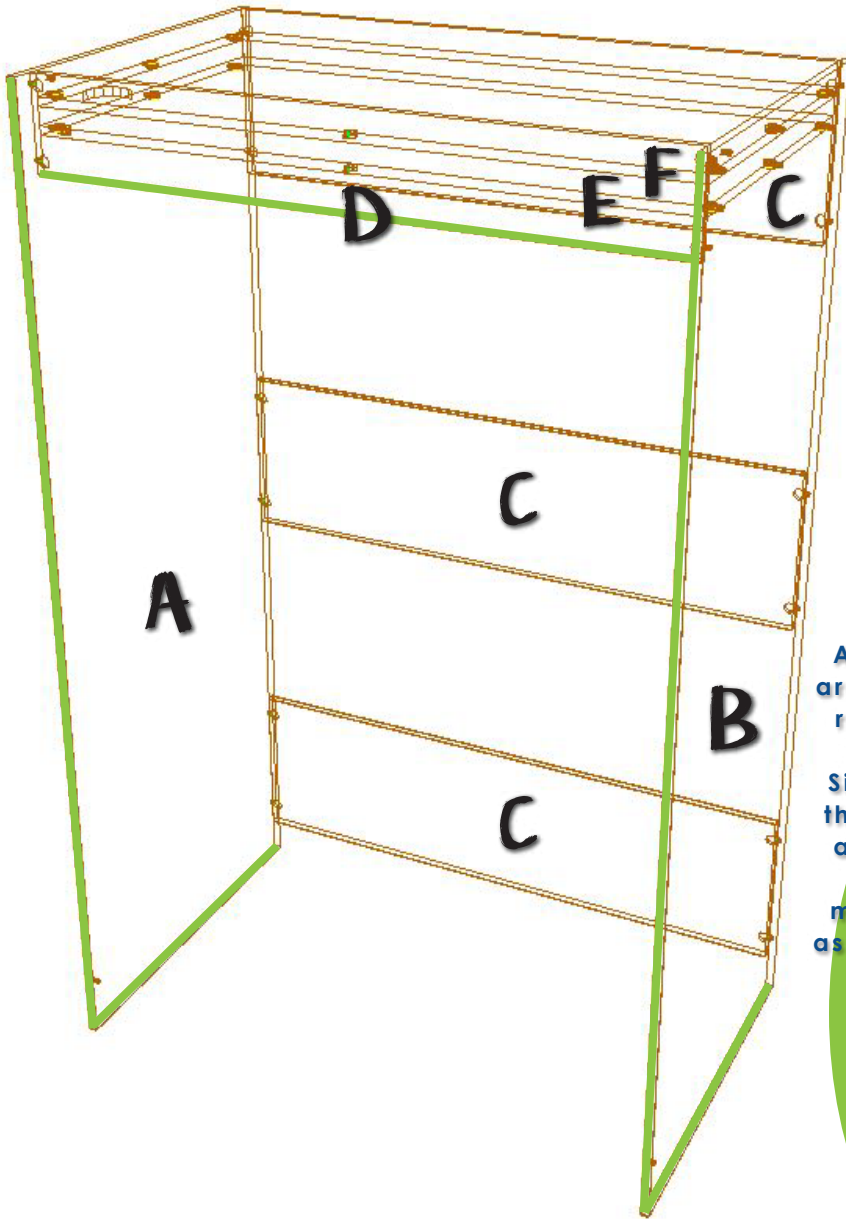

- A - LEFT Side
- B - RIGHT Side
- C - BACKS
- D - Ad PANEL
- E - LOWER TOP
- F - UPPER TOP

All stickers are a low tac removable material. Simply peel the back off and place! Adjust as many times as necessary.



* Edge Banded



Three Square Market 3329 Casey St.
River Falls, WI 54022 715.386.2233

COOLER SURROUND DOUBLE

1. Lay out all fixture pieces onto a **COMPLETELY FLAT** surface. ***Doing this on an uneven surface may produce breaks in the melamine.** Pound in all clips using the mallet and clip holder provided. ***Hold the clip holder straight up and down.** Make sure all clips are open.
2. Lay A (Left Side) on the floor, holes facing up.
3. Insert Cs (Backs) into A (Left Side). Clips should be facing the back of the fixture. Close the connected clips.
4. Insert E (Lower Top) into A (Left Side). Clips should be facing the bottom of the fixture. The hole should be positioned in the front, left corner of the fixture. Leave the clips open, for now.
5. Insert F (Upper Top) into A (Left Side). Clips should be facing the top of the fixture. The hole should be positioned in the front, left corner of the fixture, lined up with the smaller hole on E (Lower Top). Leave the clips open, for now.
6. Insert D (Ad Panel), **edge banded side facing down**, into A (Left Side), E (Lower Top), and F (Upper Top). Clips should be facing the back of the fixture. Close the connected clips. Close E and F's connected clips, now.
7. Set B (Right Side) onto the fixture, holes facing down. Work from the top of the fixture to the bottom to line up all holes. ***The rubber mallet is helpful for this.** While holding pressure down on B (Right Side), close all clips. ***Hold the bottom front corner of B (Right Side) steady during this step.**
8. Double check that ALL clips are closed.
9. Roll the fixture onto its back. ***Hold the bottom front corner of B (Right Side) steady during this step.**
10. Apply feet to the fixture. Mount LED lighting if provided.
11. **Stand the fixture up & enjoy**

**SEE THE ASSEMBLY VIDEOS
ON 32FIXTURES.COM!**

32FIXTURES.COM



Three Square Market 3329 Casey St.
River Falls, WI 54022 715.386.2233

COOLER SURROUND SINGLE

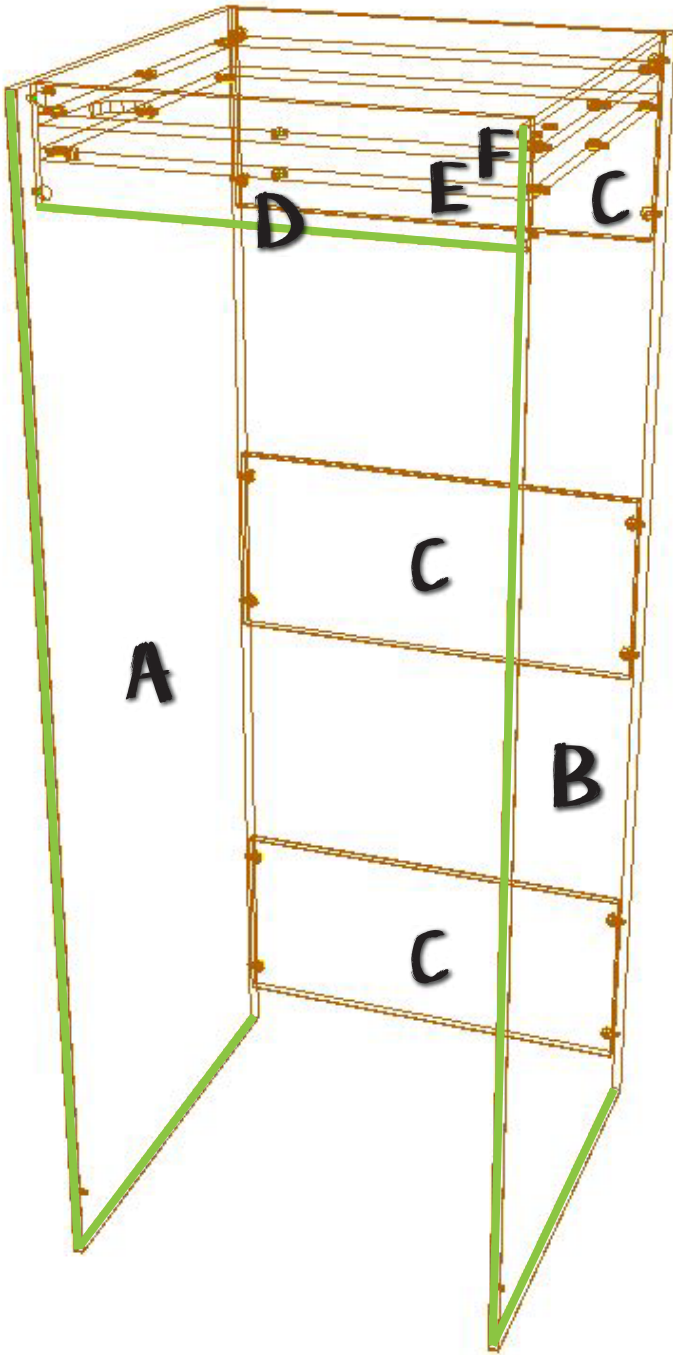

- A - Left side
- B - Right side
- C - Backs
- D - Ad Panel
- E - Lower Top
- F - Upper Top

All stickers are a low tac removable material. Simply peel the back off and place! Adjust as many times as necessary.



* Edge Banded



Three Square Market 3329 Casey St.
River Falls, WI 54022 715.386.2233

COOLER SURROUND SINGLE

1. Lay out all fixture pieces onto a **COMPLETELY FLAT** surface. ***Doing this on an uneven surface may produce breaks in the melamine.** Pound in all clips using the mallet and clip holder provided. ***Hold the clip holder straight up and down.** Make sure all clips are open.
2. Lay A (Left Side) on the floor, holes facing up.
3. Insert Cs (Backs) into A (Left Side). Clips should be facing the back of the fixture. Close the connected clips.
4. Insert E (Lower Top) into A (Left Side). Clips should be facing the bottom of the fixture. The hole should be positioned in the front, left corner of the fixture. Leave the clips open, for now.
5. Insert F (Upper Top) into A (Left Side). Clips should be facing the top of the fixture. The hole should be positioned in the front, left corner of the fixture, lined up with the smaller hole on E (Lower Top). Leave the clips open, for now.
6. Insert D (Ad Panel), **edge banded side facing down**, into A (Left Side), E (Lower Top), and F (Upper Top). Clips should be facing the back of the fixture. Close the connected clips. Close E and F's connected clips, now.
7. Set B (Right Side) onto the fixture, holes facing down. Work from the top of the fixture to the bottom to line up all holes. ***The rubber mallet is helpful for this.** While holding pressure down on B (Right Side), close all clips. ***Hold the bottom front corner of B (Right Side) steady during this step.**
8. Double check that ALL clips are closed.
9. Roll the fixture onto its back. ***Hold the bottom front corner of B (Right Side) steady during this step.**
10. Apply feet to the fixture. Mount LED lighting if provided.
11. **Stand the fixture up & enjoy**

**SEE THE ASSEMBLY VIDEOS
ON 32FIXTURES.COM!**

32FIXTURES.COM