

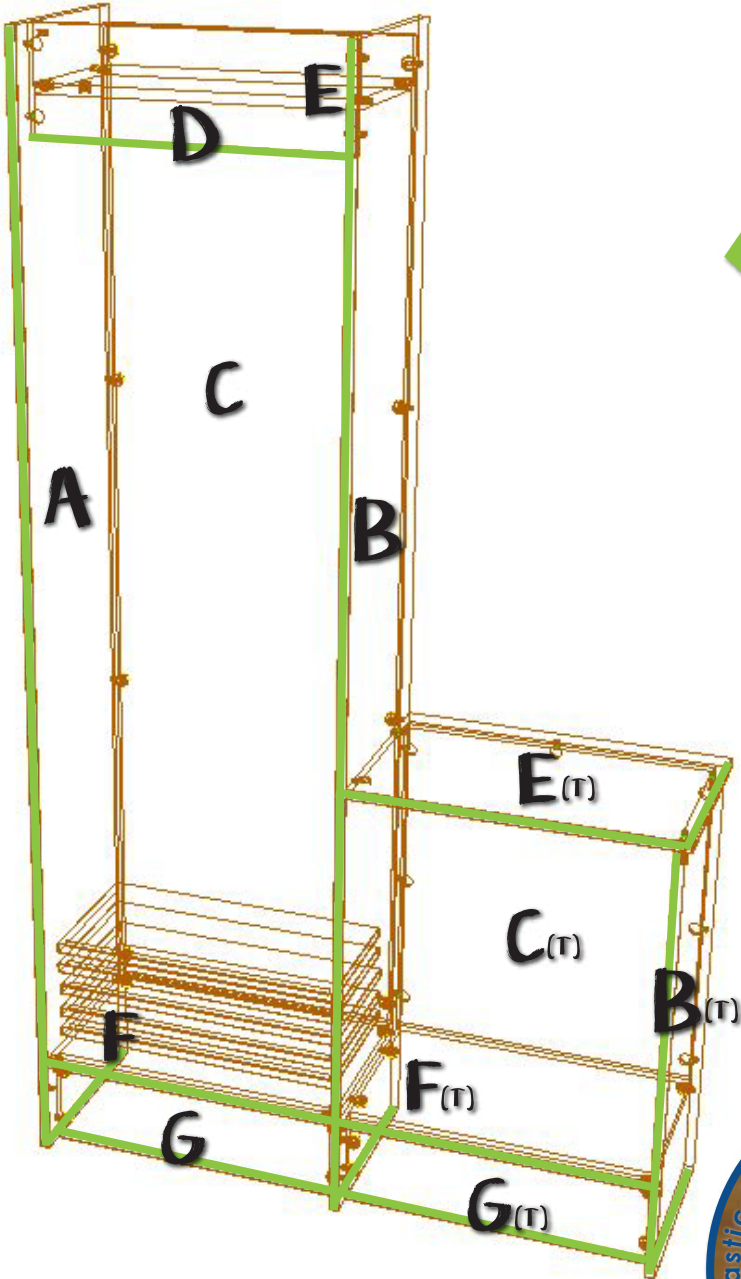

Three Square Market 3329 Casey St.  
River Falls, WI 54022 715.386.2233

# TableTOP FIXTURE (RIGHT)



- A - Left Side
- B - Right Side
- C - Back
- D - Ad Panel
- E - TOP
- F - DECK
- G - TOE Kick
- B (T) - TableTOP Right Side
- C (T) - TableTOP Back
- E (T) - TableTOP TOP
- F (T) - TableTOP Deck
- G (T) - TableTOP Toe Kick

All stickers are a low tac removable material. Simply peel the back off and place! Adjust as many times as necessary.

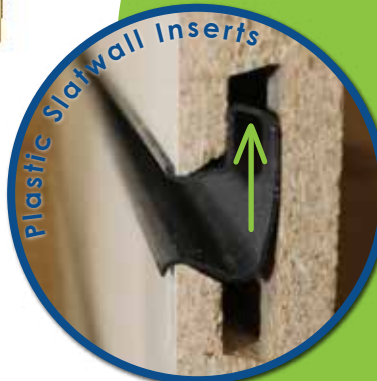

\* Edge Banded



Three Square Market 3329 Casey St.  
River Falls, WI 54022 715.386.2233

# Tabletop Fixture (Right)

1. Lay out all fixture pieces onto a **COMPLETELY FLAT** surface. **\*Doing this on an uneven surface may produce breaks in the melamine.** Pound in all clips using the mallet and clip holder provided. **\*Hold the clip holder straight up and down.** Make sure all clips are open. Place glue into each shelf cut, insert plexi glass, and leave to dry.
2. Lay A (Left Side) on the floor, holes facing up.
3. Insert C (Back) into A (Left Side). Clips should be facing the back of the fixture. Close the connected clips.
4. Insert E (Top) into A (Left Side). Clips should be facing the top of the fixture. The hole should be positioned in the front, left corner of the fixture. Leave the clips open, for now.
5. Insert D (Ad Panel), **edge banded side facing down**, into A (Left Side). Clips should be facing the back of the fixture. Close the connected clips. Close E's connected clips, now.
6. Insert F (Deck), **edge banded side facing the front of the fixture**, into A (Left Side). Clips should be facing the bottom of the fixture. Leave the clips open, for now.
7. Insert G (Toe Kick), **edge banded side facing down**, into A (Left Side). Clips should be facing the back of the fixture. Close the connected clips. Close F's connected clips, now.
8. Set B (Right Side) onto the fixture. Work from the top of the fixture to the bottom to line up all holes. **\*The rubber mallet is helpful for this.** While holding pressure down on B (Right Side), close connected clips.
9. Insert C(T) (Tabletop Back) into B (Right Side). Clips should be facing the back of the fixture. Close the connected clips.
10. Insert F(T) (Tabletop Deck), **edge banded side facing the front of the fixture**, into B (Right Side). Clips should be facing the bottom of the fixture. Leave the clips open, for now.
11. Insert G(T) (Tabletop Toe Kick), **edge banded side facing down**, into B (Right Side). Clips should be facing the back of the fixture. Close the connected clips. Close F(T)'s connected clips, now.
12. Insert E(T) (Tabletop Top) into B (Right Side). Clips should be facing the bottom of the fixture. Leave the clips open, for now.
13. Set B(T) (Tabletop Right Side) onto the fixture. Work from the top of the fixture to the bottom to line up all holes. **\*The rubber mallet is helpful for this.** While holding pressure down on B(T) (Tabletop Right Side), close connected clips.
14. Double check that ALL clips are closed.
15. Roll the fixture onto its back.
16. Set the slatwalls into place. **\*Putting a plastic insert into the very bottom, between the slatwall and F (Deck), is helpful for lining it up correctly.**
17. Screw the slatwalls into place, lining screws into slat grooves. **\*We recommend using 1" sheetrock screws.**
18. Insert all plastic slatwall inserts. **\*The lip of the insert should face the top of the fixture (see image on other side).** Apply feet to the fixture. Mount LED lighting if provided.
19. **Stand the fixture up, place shelves, & enjoy**

**SEE THE ASSEMBLY VIDEOS  
ON 32FIXTURES.COM!**

**32FIXTURES.COM**



Three Square Market 3329 Casey St.  
River Falls, WI 54022 715.386.2233

# COOLER SURROUND SINGLE

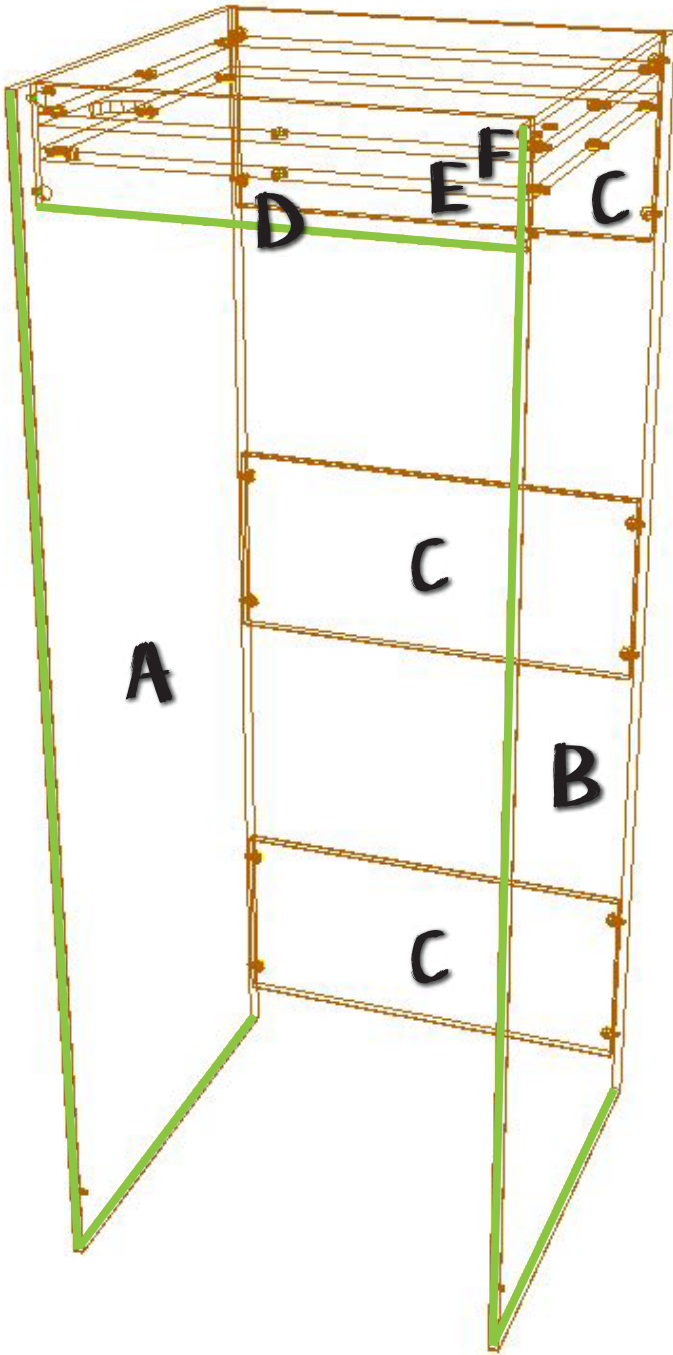

- A - Left Side
- B - Right Side
- C - Backs
- D - Ad Panel
- E - Lower Top
- F - Upper Top

All stickers are a low tac removable material. Simply peel the back off and place! Adjust as many times as necessary.



\* Edge Banded



Three Square Market 3329 Casey St.  
River Falls, WI 54022 715.386.2233

# COOLER SURROUND SINGLE

1. Lay out all fixture pieces onto a **COMPLETELY FLAT** surface. **\*Doing this on an uneven surface may produce breaks in the melamine.** Pound in all clips using the mallet and clip holder provided. **\*Hold the clip holder straight up and down.** Make sure all clips are open.
2. Lay A (Left Side) on the floor, holes facing up.
3. Insert Cs (Backs) into A (Left Side). Clips should be facing the back of the fixture. Close the connected clips.
4. Insert E (Lower Top) into A (Left Side). Clips should be facing the bottom of the fixture. The hole should be positioned in the front, left corner of the fixture. Leave the clips open, for now.
5. Insert F (Upper Top) into A (Left Side). Clips should be facing the top of the fixture. The hole should be positioned in the front, left corner of the fixture, lined up with the smaller hole on E (Lower Top). Leave the clips open, for now.
6. Insert D (Ad Panel), **edge banded side facing down**, into A (Left Side), E (Lower Top), and F (Upper Top). Clips should be facing the back of the fixture. Close the connected clips. Close E and F's connected clips, now.
7. Set B (Right Side) onto the fixture, holes facing down. Work from the top of the fixture to the bottom to line up all holes. **\*The rubber mallet is helpful for this.** While holding pressure down on B (Right Side), close all clips. **\*Hold the bottom front corner of B (Right Side) steady during this step.**
8. Double check that ALL clips are closed.
9. Roll the fixture onto its back. **\*Hold the bottom front corner of B (Right Side) steady during this step.**
10. Apply feet to the fixture. Mount LED lighting if provided.
11. **Stand the fixture up & enjoy**

**SEE THE ASSEMBLY VIDEOS  
ON 32FIXTURES.COM!**

**32FIXTURES.COM**